

# High-Performance Lab Tables

## 63-500系列 高性能防震台

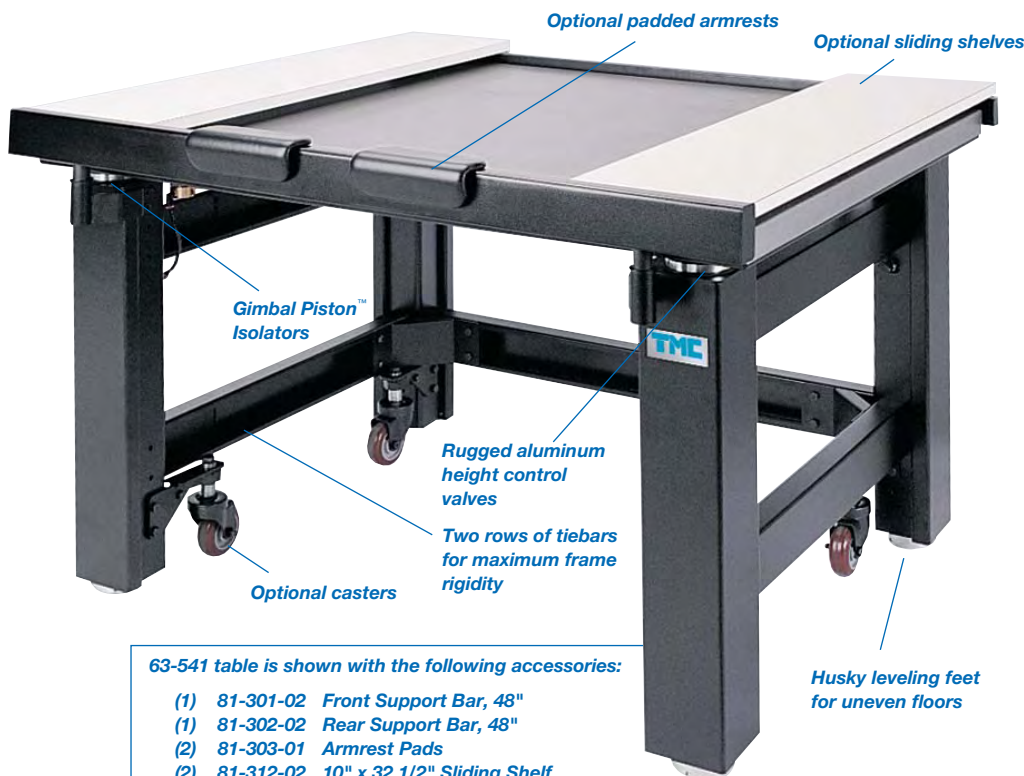

63-541 table is shown with the following accessories:

- (1) 81-301-02 Front Support Bar, 48"
- (1) 81-302-02 Rear Support Bar, 48"
- (2) 81-303-01 Armrest Pads
- (2) 81-312-02 10" x 32 1/2" Sliding Shelf
- (1) 83-014-01 Retractable Casters

Accessories for 63-500 Lab Tables are specified separately and listed in the Ordering Chart on Page 9.

TMC 63-500 Series High-Performance Lab Tables provide an excellent vibration-free working surface for loads up to 350 lb (160 kg). Now with modular construction, these tables are recommended for use in such diverse applications as electrophysiology, cell injection, ultramicrotomy, photomicroscopy, scanning tunnel microscopy, and confocal laser scanning microscopy.

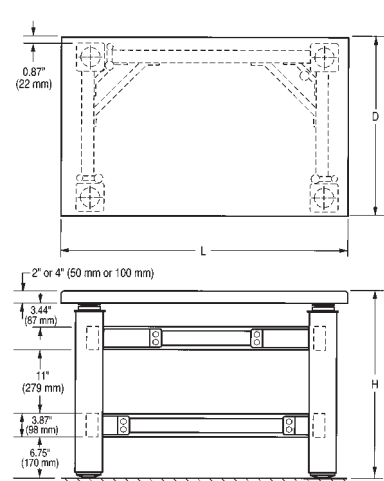

### GENERAL SPECIFICATIONS

#### Isolator natural frequency:

##### High Input

Vertical = 1.2 Hz

Horizontal = 1.0 Hz

##### Low Input

Vertical = 1.5 - 2.0 Hz

Horizontal = 1.2 - 1.7 Hz

#### Isolation efficiency @ 5 Hz:

Vertical = 70 - 85%

Horizontal = 75 - 90%

#### Isolation efficiency @ 10 Hz:

Vertical = 90 - 97%

Horizontal = 90 - 97%

#### Gross load capacity:

1,400 lb (640 kg)

#### Net load capacity:

350 lb (160 kg)

**Finish:** Medium texture black powder coat frame, stainless steel top

#### Facilities required:

80 psi nitrogen or air

**63-531 Vibration Isolation Performance**  
(actual measured data)

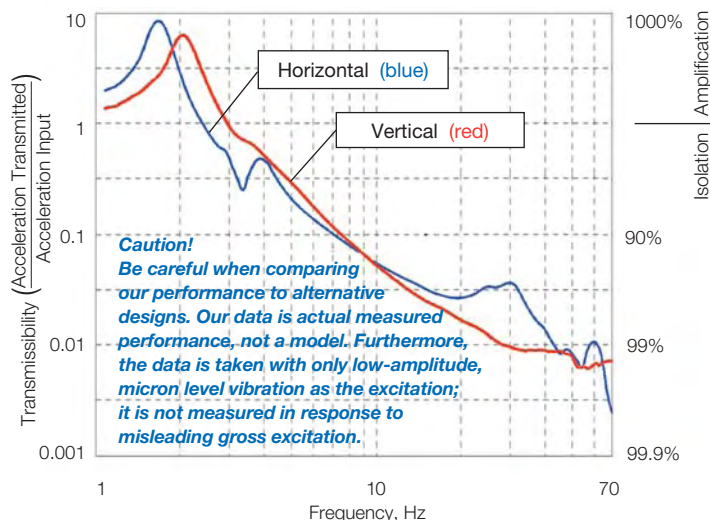

## Features

### Gimbal Piston™ Isolators.

Our Gimbal Piston™ Isolator has been proven by independent tests to consistently outperform the competition. It achieves both horizontal and vertical isolation down to very low input levels.

### Thin-Wall Rolling Diaphragms.

An integral part of the Gimbal Piston, the thin-wall, dacron-reinforced, rolling diaphragm air seals are only 0.020 in. (0.5 mm) thick and extremely flexible. They do not stiffen the spring as thicker rubber diaphragms do.

### Aluminum Height Control Valves.

All systems are equipped with rugged aluminum height control valves. Virtually unbreakable, they are finger adjustable with no need for tools. The standard model maintains height to  $\pm 0.050$  in. ( $\pm 1$  mm); the precision model, to  $\pm 0.005$  in. ( $\pm 0.1$  mm).

### Internal Piston Travel Restraint.

Unique in the industry, TMC provides husky, tamper-proof, built-in piston travel restraints. The restraints are completely independent of the table valves and have been ram-tested at forces above those produced by the pistons operating at full pressure. They cannot be decoupled accidentally and

do not interfere with setting up and using the table, but simply protect against overtravel without the use of external bars that create hazardous pinch points. Heavy loads, including the top plate, can be safely removed from a table in full operation.

### Tiebar Gussets.

Exclusive TMC tiebar gussets increase table frame rigidity. They compensate for the elimination of the front tiebar in order to provide kneewell space.

### Rugged Built-in Leveling Feet.

Table legs include built-in fine-thread 3 in. (75 mm) diameter screw jack levelers with 1/2 in. (13 mm) travel, provision for external adjustment, and

a handy adjustment wrench. The base is a solid, slightly domed shape to assure solid, wobble-free contact with sloping or irregular floors.

### Superior TableTops™.

Our standard laminated tops provide an attractive stainless steel ferromagnetic working surface with highly damped, high stiffness construction at low cost. For applications requiring the ultimate stiffness and damping or mounting holes, specify our patented CleanTop® II honeycomb top.

### How to Order

See Ordering chart on Page 9.

## Which Top Is Best for You?

**Stainless Steel Laminate**, our least expensive 63-500 top, is recommended for applications that require a strong magnetic attachment and will not involve repeated exposure of the top to corrosive liquids. However, stains from such liquids can be removed with an industrial strength stainless steel cleaner. This top does not have the precision flatness of our CleanTop II honeycomb top. Flatness is  $\pm 0.030$  in. ( $\pm 0.8$  mm).

**Plastic Laminate on Stainless Steel** is an easy-to-clean alternative to stainless steel, without sacrificing structural performance. A plastic laminate is added to the top surface, which reduces ferromagnetic attachment strength.

**CleanTop II** features TMC's patented spill-proof, drilled and tapped mounting hole array. Tops are 4 in. (100 mm) thick and have 1/4–20 holes on 1 in. spacing or M6 holes on 25 mm spacing. The small cell-size steel honeycomb design provides even stiffer and better damping than our stainless steel laminate. Guaranteed flat to  $\pm 0.005$  in. ( $\pm 0.13$  mm). For more information, see Section 2.



*Scientifica Limited's unique SliceMaster enables one operator to take independent electrophysiological recordings from up to eight brain slices simultaneously, controlling all eight slice chambers from one workstation. The system minimizes repetitive tasks, improves statistical analysis, and reduces the use of animals. Each two-tier TMC table supports four stations with a temperature-controlled chamber and camera on the top tier and the stimulator and recording manipulators on the lower breadboard, freeing up valuable workspace in the laboratory. The whole rigid assembly is isolated on TMC's patented Gimbal Piston™ Air Isolators.*